

US Instrument tray layouts



Set number:

75210299

POLARSTEM[®] Instrument Tray I
(bottom of double stack tray)

Catalog #	Item #	Description	Qty	Ref
75100214	21000676	POLARSTEM Tray	1	
75007661	990019	Tray Lid	1	
75007308	600921	Offset Adaptor 40mm*	2	A
75023019	21000616	Trial Rasp 01**	1	B
75004641	21000291	Trial Rasp 0	1	C
75004642	21000292	Trial Rasp 1	1	D
75004643	21000293	Trial Rasp 2	1	E
75004644	21000294	Trial Rasp 3	1	F
75004645	21000295	Trial Rasp 4	1	G
75004646	21000296	Trial Rasp 5	1	H
75004647	21000297	Trial Rasp 6	1	I
75004648	21000298	Trial Rasp 7	1	J
75004649	21000299	Trial Rasp 8	1	K
75018110	21000592	Trial Rasp 9	1	L
75018111	21000593	Trial Rasp 10	1	M
75023020	21000617	Trial Rasp 11***	1	N
75102213	75102213	Valgus Trial Neck	1	O
75023370	21000645	Trial Neck Standard 0	1	P
75004639	21000289	Trial Neck Standard 1-11	1	Q
75004640	21000290	Trial Neck Lateralized 1-11	1	R
75000642	21000378	Modular Knock/Strike Plate (small)	1	S
75001747	1060909	Anteverson Bolt	1	T
75004665	21000341	Box Chisel	1	U
75004666	21000342	Rod for Box Chisel	1	V

* The single offset (40mm adaptor) comes standard in each set. The straight and dual offset handles can be ordered separately. See surgical technique for ordering info. Available in the US.

** The size 01 broach is a starter rasp. There is not a size 01 stem, in the US.

*** The size 11 rasp does not come standard on the tray and must be ordered seperately.

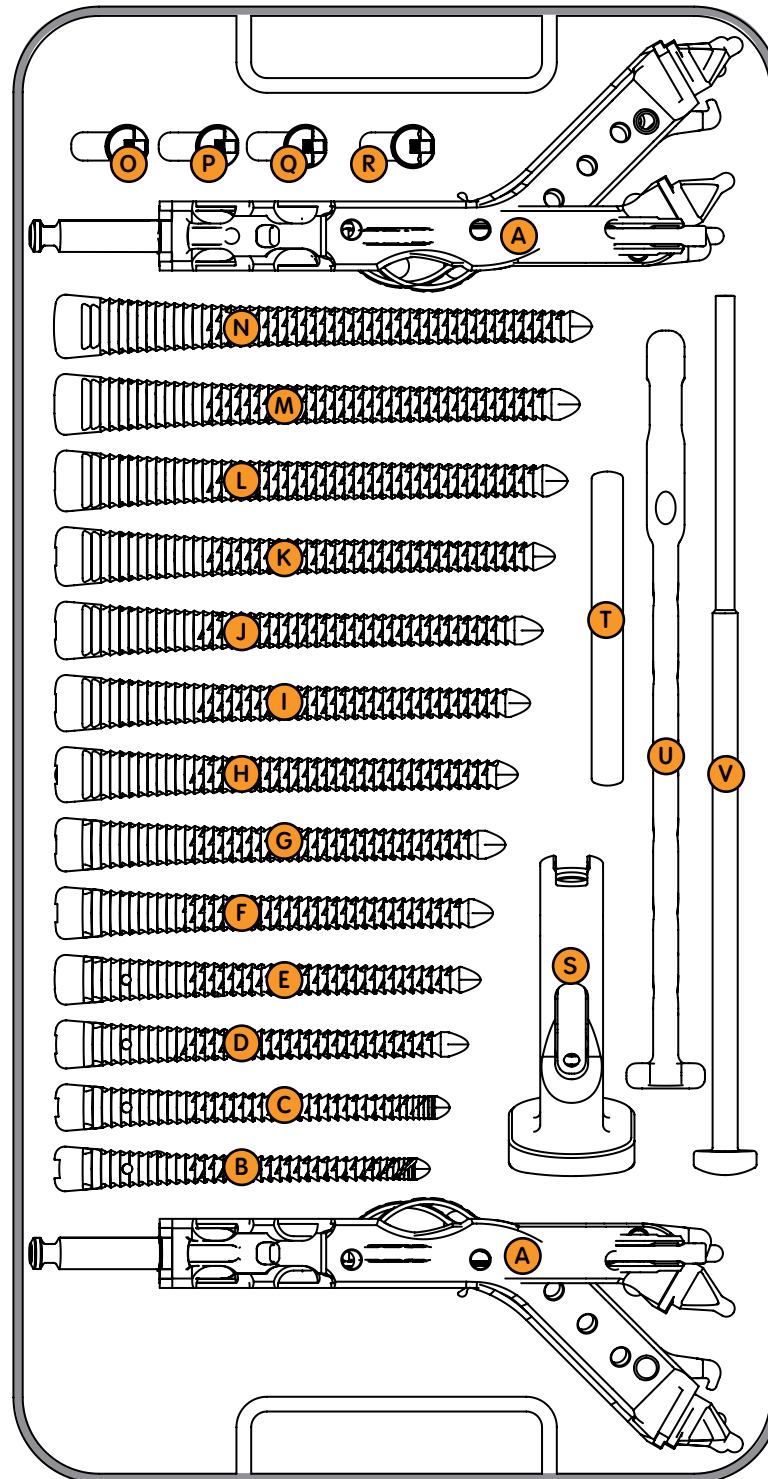

Set number:

75210299

POLARSTEM[®] Instrument Tray II

(top of double stack tray)

Catalog #	Item #	Description	Qty	Ref
75002165	110249	Extraction Screw	1	A
75004678	21000354	Extraction Block	1	B
75004664	21000340	Pin for CCD Gauge 100 mm	1	C
75023369	21000644	Stem Impactor	1	D
75004667	21000343	Femoral Reamer	1	E
75023710	21000662	Head Impactor	1	F
75023711	21000663	Modular Head for Impactor	1	G
75100844	75100844	Trial Femoral Head 28 S/+0	1	H
75100845	75100845	Trial Femoral Head 28 M/+4	1	I
75100846	75100846	Trial Femoral Head 28 L/+8	1	J
75100847	75100847	Trial Femoral Head 28 XL/+12	1	K
75100850	75100850	Trial Femoral Head 32 S/+0	1	L
75100851	75100851	Trial Femoral Head 32 M/+4	1	M
75100852	75100852	Trial Femoral Head 32 L/+8	1	N
75100853	75100853	Trial Femoral Head 32 XL/+12	1	O
75100856	75100856	Trial Femoral Head 36 S/+0	1	P
75100857	75100857	Trial Femoral Head 36 M/+4	1	Q
75100858	75100858	Trial Femoral Head 36 L/+8	1	R
75100859	75100859	Trial Femoral Head 36 XL/+12	1	S

Not pictured

Catalog #	Item #	Description	Qty
75100843	75100843	Trial Femoral Head 28 XS/-3	1
75100848	75100848	Trial Femoral Head 28 XXL/+16	1
75100849	75100849	Trial Femoral Head 32 XS/-3	1
75100854	75100854	Trial Femoral Head 32 XXL/+16	1
75100855	75100855	Trial Femoral Head 36 XS/-3	1

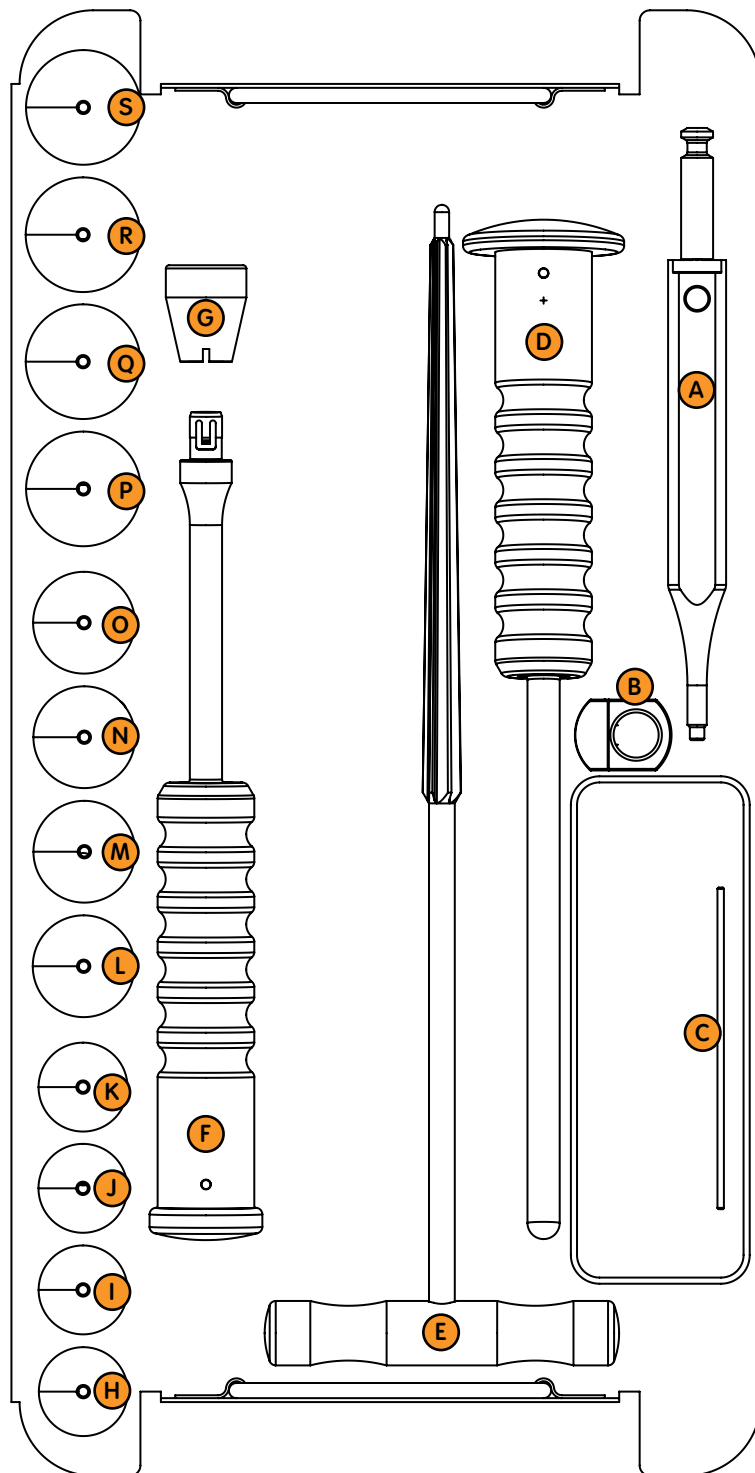

Set number:

75210301

POLARSTEM[®] Add-On Tray

Catalog #	Item #	Description	Qty	Ref
75102199	75102199	Collar Case	1	
75007661	990019	Tray Lid	1	
75102237	75102237	DAA Offset Adapter Left	2	A
75004495	21000138	MIA curved rasp	1	B
75102207	75102207	Calcar Reamer Small	1	C
75102208	75102208	Calcar Reamer Large	1	D
75102240	75102240	DAA Offset Adapter Right	2	E
75102239	75102239	POLARSTEM Starter Rasp	1	F
75102238	75102238	Modular Knock plate large	2	G
75102261	75102261	Fin Stabilizer for 21000438	1	H
75102205	75102205	Calcar Reamer Guide	1	I
75102202	75102202	Trial Neck with Collar STD 0	1	J
75102204	75102204	Trial Neck with Collar LAT 1-11	1	K
75102203	75102203	Trial Neck with Collar STD 1-11	1	L
75102260	75102260	Cardan for 21000438	1	M
75000675	21000438	Stem Impactor Curved	1	N

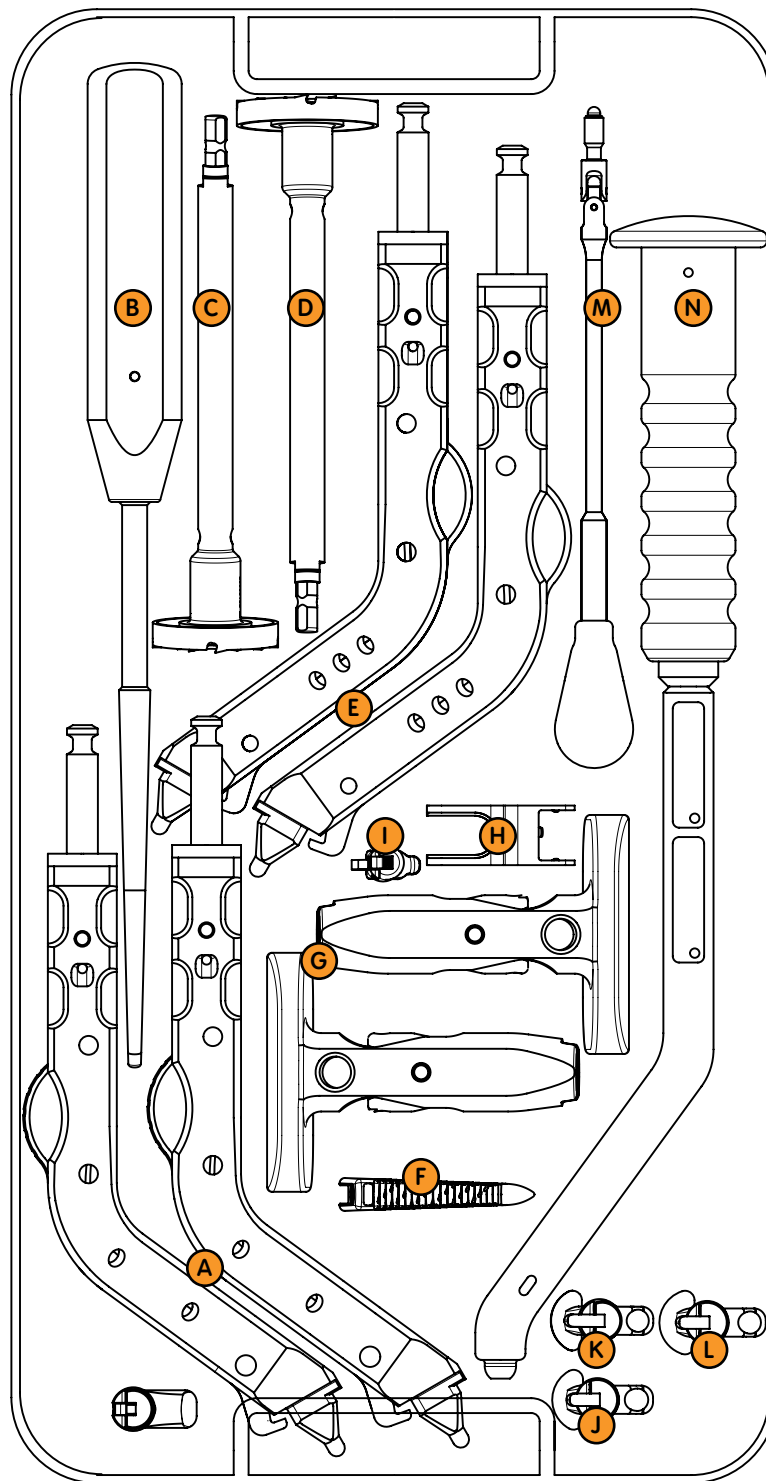

Smith & Nephew, Inc.
 Smith & Nephew Orthopaedics AG
 Oberneuhofstrasse 10d
 6340 Baar
 Switzerland

www.smith-nephew.com

Telephone: 1-901-396-2121
 Information: 1-800-821-5700
 Orders and Inquiries: 1-800-238-7538

[®]Trademark Smith & Nephew. Reg. US Pat. & TM Off.

©2016 Smith & Nephew
 04529 V2 02/16